

### 8 Install Hard Drives/Carriers

Repeat these steps for each installed hard drive

**A** Remove the drive carrier by pressing the green button and opening the lever. Then slide the carrier out.

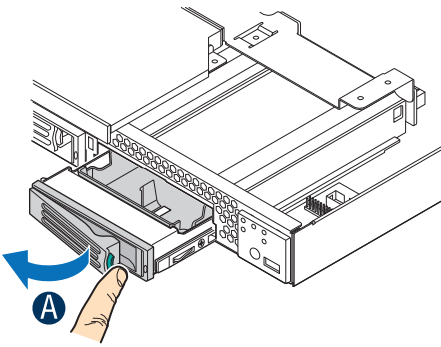

**B** Remove the four screws securing the air baffle and remove the baffle.  
**C** Install the hard disk drive using the same four screws as shown. Make sure the connector end of the drive matches the backplane connector.

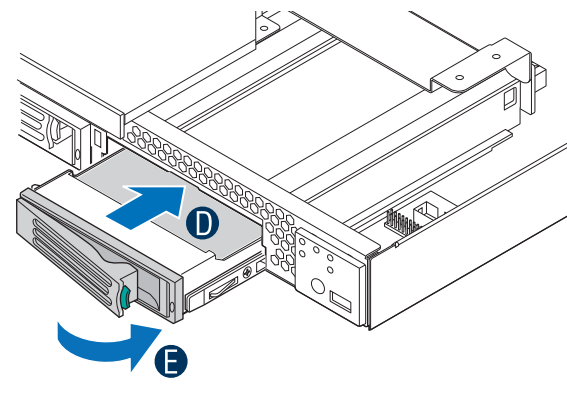
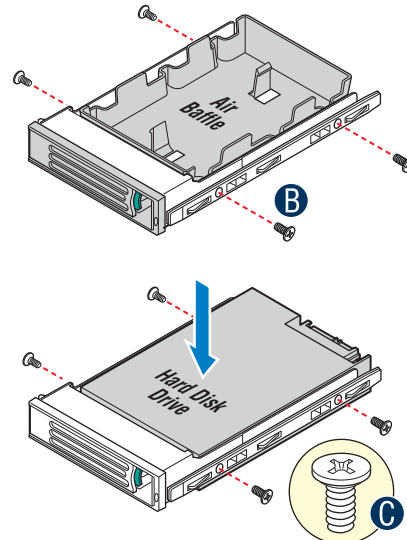

**D** With the lever open, insert the hard disk drive assembly into the chassis opening and push until the locking lever engages.  
**E** Push in the rest of the way until the lever locks into place.

Note: System ships with SATA Hard Drives pre-cabled from the backplane to the server board.

**CAUTION:** If you install less than three drives or devices, empty drive bays must be occupied by carriers with baffles to maintain proper system cooling.

### 9 Install PCI Add-in Card(s)

**A** Remove filler panel from the selected add-in card slot.  
**B** Insert add-in card until it seats in the riser connector.  
**C** Secure add-in card with screw as shown.

**CAUTION:** Observe normal ESD precautions when installing add-in cards.  
 Note: Add-in card install sequence for low-profile add-in cards on opposite side of PCI riser is the same.

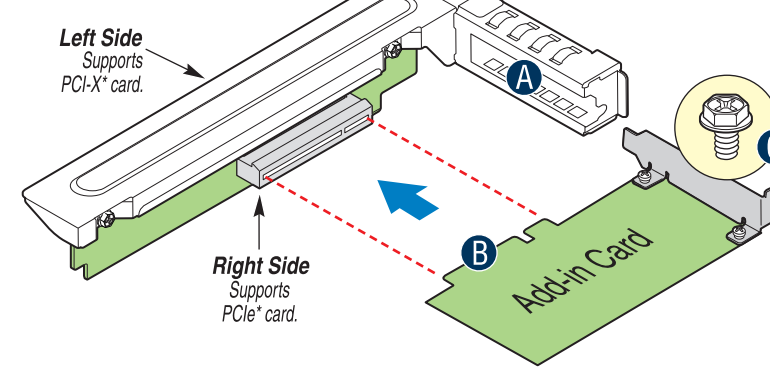

### 10 Install PCI Add-in Card Riser Assembly

**A** Align the riser card with the server board riser socket.  
**B** Before pressing into place, make sure the three hooks engage the three slots on the back panel top edge.

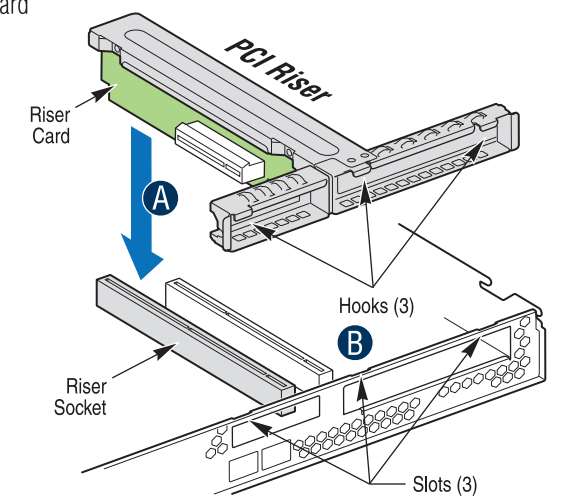

### 11 Install Air Baffle

Install processor air duct as shown.

Use care to avoid pinching system cables.

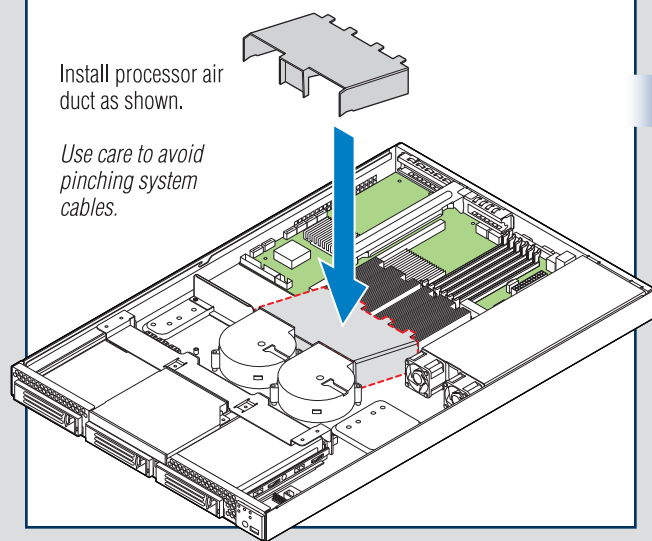

### 12 Install Slimline Optical Drive (optional)

See the Server System User's Guide for installation instructions.

### 13 Install the Top Cover

**A** Place cover onto chassis and slide forward.  
**B** Install four screws at front.

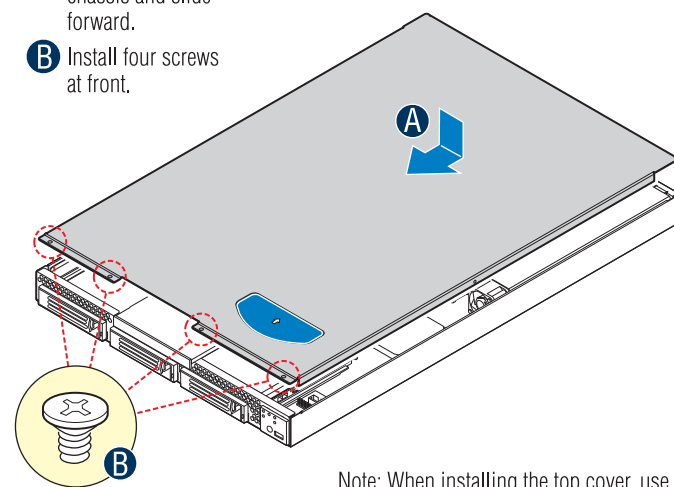

Note: When installing the top cover, use care to avoid pinching system cables.

### 14 Install Rack Handles

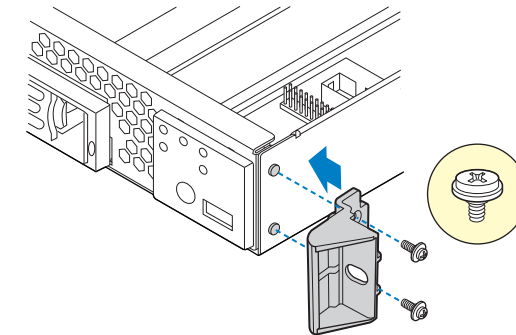

### 15 Install Rail Kit (optional)

See the documentation that came with your selected rail kit for installation instructions.

### 16 Install Bezel (optional)

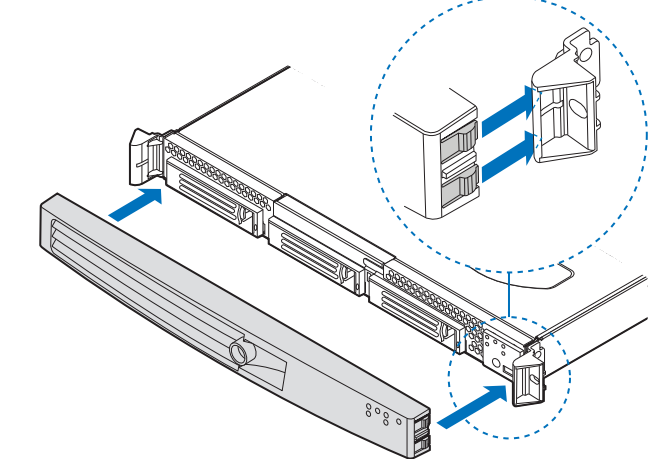

### 17 Finishing Up

Before installing your operating system, you must finish your system installation and connect back panel I/O connectors and AC power.

- Make sure you have replaced the system cover.
- Connect your keyboard, mouse, video and other I/O cables/devices as shown. Then connect the AC power cord.

**CAUTION:** This unit must be operated with the TOP COVER installed to ensure proper cooling.

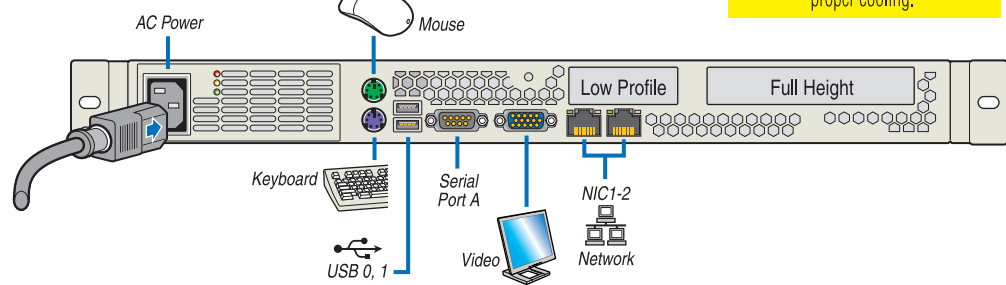

### 18 Install Software • BIOS, Drivers, and Operating System Install

**A. Confirm BIOS Version:** Look on the Server/System Management screen in the BIOS Setup Utility to determine the installed BIOS version. Compare this to the versions at: <http://support.intel.com/support/motherboards/server/s5000vcl>. If new versions are available, update the BIOS on your server. See the User Guide on the Intel® Server Deployment Toolkit 2.0 CD for update instructions.

**B. Configure your RAID Controller:** Use the instructions provided with the RAID controller.

**C. Install your Operating System:** Use the instructions provided with the RAID controller and with the operating system.

**D. Install Operating System Drivers:** With the operating system running, insert the Intel® Server Deployment Toolkit 2.0 CD. If using a Microsoft® Windows® operating system, the Express Installer will autorun and allow you to select the appropriate drivers to install. On other operating systems, browse the CD folders to locate and install the driver files.

### Platform Cabling Diagram

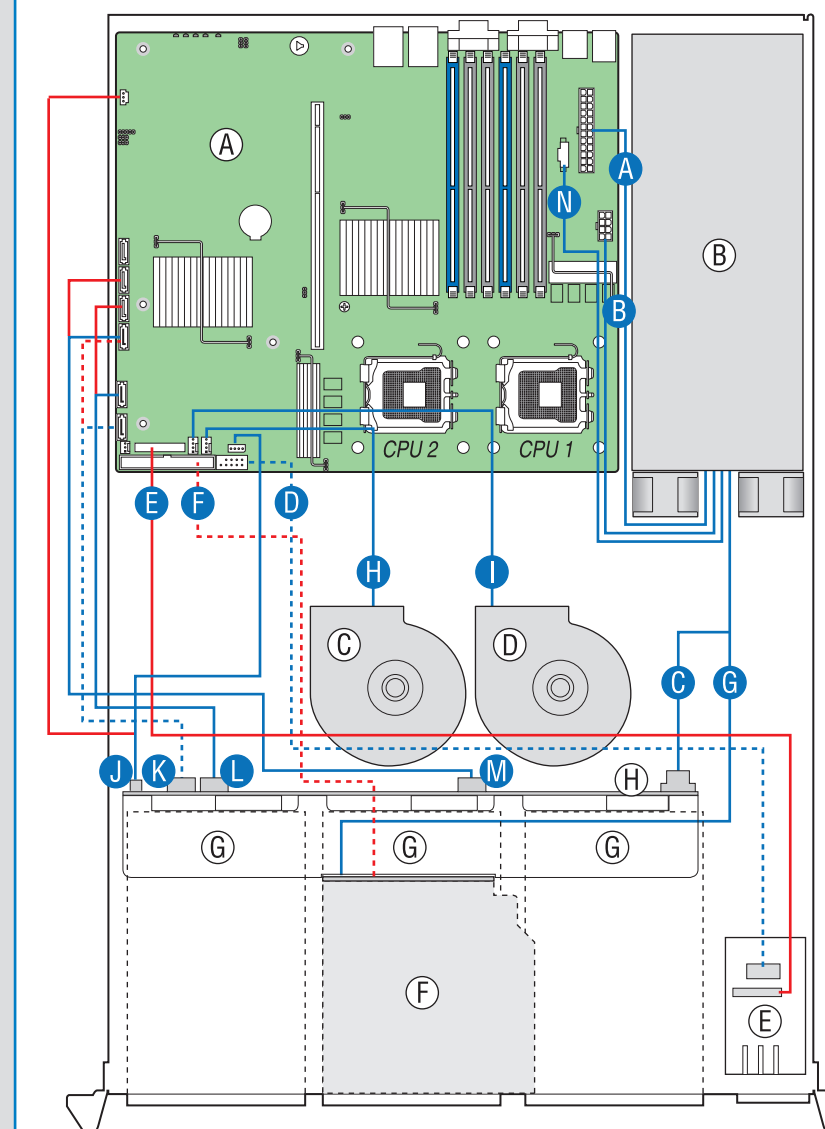

- (A) Server Board
  - (B) Power Supply
  - (C) Blower Fan #1
  - (D) Blower Fan #2
  - (E) Front Panel Board
  - (F) Optical Drive
  - (G) Hard Disk Drive Bays
  - (H) Backplane
- (A) Power to Server Board (Main)
  - (B) Power to Server Board (CPU)
  - (C) Power to Backplane
  - (D) Front Panel USB
  - (E) Front Panel
  - (F) Optical Device Data Cable
  - (G) Optical Device Power
  - (H) Blower Fan #1 Power
  - (I) Blower Fan #2 Power
  - (J) SPGIO to Server Board (SATA/SAS)
  - (K) HDD 0 to Server Board SATA/SAS0
  - (L) HDD 1 to Server Board SATA/SAS1
  - (M) HDD 2 to Server Board SATA/SAS2
  - (N) Power to Server Board (Auxiliary)

#### Front Panel Controls and Indicators (shown with bezel removed)

- A. NIC1 LED
- B. NIC2 LED
- C. Power LED
- D. Status LED
- E. HDD Activity LED
- F. USB 2.0 Port
- G. Power Button

#### Intel® Server Board S5000VCL Component Layout

See your Intel® Server Board S5000VCL User's Guide for expanded component and connection information.

Optional Accessories and Order Codes	
400 Watt Power Supply	FHJ400WPS
System Blower Fan Spare	FHJBLOWER
Hot-Swap Chassis Product Maintenance Kit	FHJHSPMKIT
PCI-X* (ML/LP) / PCIe* (SL/LP) Riser Card	AHJPCIRISER1U
Dual PCIe* Riser Card	AHJPCIRISER
Slimline CD-ROM Drive Accessory	AXXSCD
Slimline DVD-ROM Drive Accessory	AXXDVDROM
Slimline DVD-ROM/CDRW Accessory	AXXDVDCDR
Passive Hot-Swap Backplane Kit	FSR1530BPASATA

A complete list of accessories and spares can be found at: [www.intel.com/go/serverbuilder](http://www.intel.com/go/serverbuilder)

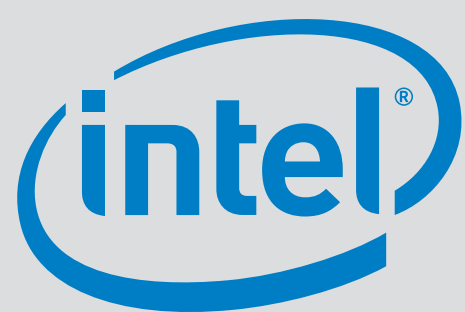

Reference